

IPG4 ADDENDUM

rev.2

CONSTRUCTION SUPPLIES FOR SERIOUS USERS



www.iccons.com.au

GENERAL

- Inner Carton Quantity
- Outer Carton Quantity
- Drill Diameter

HEAD STYLES

- Phillips
- Phillips (Button Head)
- Pozi
- Square
- Torx
- Hex (Internal)
- Hex with Internal Torx
- Hex Head
- Hex Flanged
- Nut-setter

ANCHORING

- Head Width
- Thread Width
- Thread length
- Minimum Embedment Depth
- Minimum Hole depth
- Maximum Material Thickness
- Splice Anchor Fixture Thickness
- Metal Drive and Nylon Anchor Fixture Thickness
- Wall Anchor Fixture Thickness
- Toggle Strap Wall Thickness
- Strike Anchor Fixture Thickness
- Grip Nut Wall Thickness
- Clearance hole
- Thread length

ANCHORING cont.

- Countersunk Head Height
- Countersunk Head Width
- Internal Thread
- Eye Hole Diameter
- Maximum Torque
- Purlin Material Thickness
- Screw-bolt Eye
- Beam Clamp Depth
- Beam Clamp Clearance Hole

ADHESIVES

- Anchor Width
- Plug Length
- Threaded Insert Length
- Threaded Insert Diameter

CONCRETE NAILING SYSTEMS

- Nail Head Width
- Nail Shank Width
- Nail Length
- Washer Diameter
- Channel Strut Width
- Channel Strut Depth
- Channel Strut Length
- Pipe Diameter
- Insulation Thickness
- Rivets Body Diameter
- Rivets Length
- Rivets Grip Range

SCREWS

- Head Width
- Shank Width
- Length
- Shank Length
- Material Thickness
- Minimum Embedment
- Head Style

DRILLING

- Drill Diameter
- Drill Working Length
- Drill Total Length
- Chisel Head Width
- Hole Saw Diameter
- Hole Saw Length
- Hole Saw Thread

DIAMOND

- Hole Diameter
- Disk Diameter
- Core Diameter
- Core Length

Screw Conversion Gauge to mm	
Gauge	mm
4	2.9
6	3.5
8	4.2
10	4.8
12	5.5
14	6.3

This publication is copyright. No part of this publication may be reproduced without the prior written consent of ICCONS® Pty Ltd. ICCONS® Pty Ltd is committed to continued product development & improvement, therefore ICCONS® Pty Ltd reserves the right to alter product specification as required. ICCONS® Pty Ltd has made every effort to ensure information included in this product guide is correct at the time of printing, it is the responsibility of the user to ensure product selected is suitable for their application. ICCONS® Pty Ltd. Accept no responsibility or liability for any errors or omissions. This product guide should be used as a guide only, ICCONS® Pty Ltd fully exclude any liability to any person in respect of, or arising out of any reliance by such person on any contents of this publication for any purpose. For further information go to www.iccons.com.au or contact ICCONS® Pty Ltd.

THUNDERBOLT PRO XTM Screw-bolts



NCC
ETA

Zinc Clear & Galv

P4

NEW

The Original
BLUE RANGER HANGER



New M16 & M20 size

BBPIP1620

P6

NEW

XTM Drop-ins - Standard & Lip



NCC
ETA

Zinc & Stainless Steel

P7

NEW

Packing Shims



90mm Length

P8

NEW

TOCCLEBITE



For Plasterboard

P9

NEW

THE BETTER BIT



For Fibre Cement Board

P9

NEW

X3 Nylon Frame Fixing



FRULSIDER
YOUR FIXING FACTORY

Hex & Countersunk

P13

NEW

Pure-Epoxy GEN®



NCC
ETA

100+
www.iccons.com.au

More features Higher Performance

P16

NEW

Hybrid GEN®



NCC
ETA

Suitable for Dustless drill bits

P17

NEW

GT-6IXF



Gas Nailer

P19

NEW

GTIXF-160C



Gas Insulation Fastening Tool

P21

NEW

STRUCTNAIL®
specialised steel fasteners



Specialised Steel Fasteners

P22

NEW

RoofStarPro™
For Corrugated Sheet to Metal Battens



13-11 x 38

P28

NEW

SD & Needle screws



5 Series

Hex, Button, CSK & Wafer

P29

NEW

STET Aesthetic Architectural Tamper Resistant Screw

FRULSIDER
YOUR FIXING FACTORY



Coarse Thread & 5 Series Fine Thread

P31

NEW

heller Enduro SDS MAX New sizes



heller SDS Plus SET-SAFE DE - CASE

P32

NEW

FASTDRIVE



Power Tool Accessories

P34

NEW

B+BTEC

Karat 180 Diamond Coring Rig



P47

NEW



INCLUDES AS5216:2018 COMPLIANT RANGE

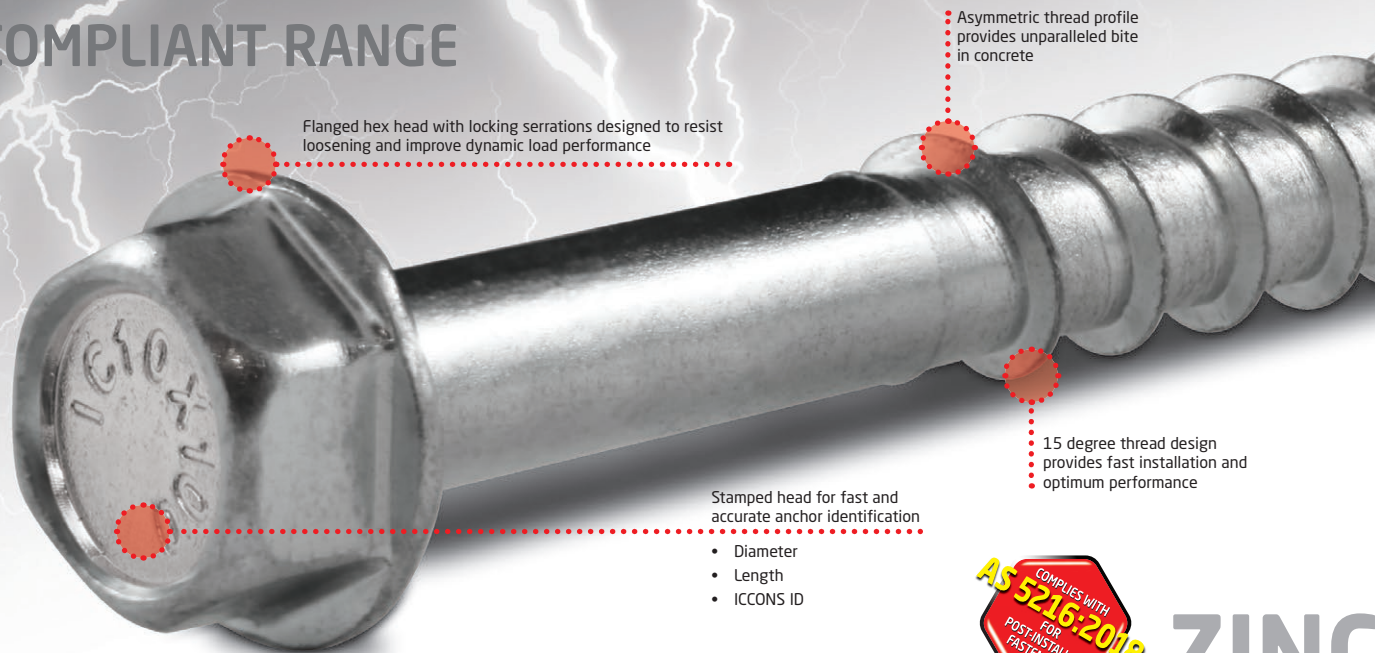

Flanged hex head with locking serrations designed to resist loosening and improve dynamic load performance

Asymmetric thread profile provides unparalleled bite in concrete

15 degree thread design provides fast installation and optimum performance

Stamped head for fast and accurate anchor identification

- Diameter
- Length
- ICCONS ID



ZINC

ThunderBolt[®] Pro-XTM Hex Head



Zinc Clear



NEW

ZINC INTERNAL

Part No.	Description	mm	Drill Depth mm	Clearance mm	mm	mm	Socket mm	T _{inst} (Nm)	T _{max} (Nm)	ETA Option	qty	qty
SXTM05050	5 x 50mm	5	35	7	25	25	8	15	80	n/a	100	800
SXTM06030	6 x 30mm	6	35	9	25	5	10	20	80	n/a	100	800
SXTM06050	6 x 50mm		40		30	20				n/a	100	800
SXTM06060-A	6 x 60mm		65		55	5				RNSS	100	600
SXTM06075-A	6 x 75mm		65		55	20				RNSS	100	600
SXTM06100-A	6 x 100mm		65		55	45				RNSS	100	600
SXTM08050	8 x 50mm	8	50	11	40	10	13	40	185	n/a	100	400
SXTM08060	8 x 60mm		50		40	20				n/a	100	400
SXTM08075-A	8 x 75mm		75		65	10				Option 1	100	400
SXTM08100-A	8 x 100mm		75		65	35				Option 1	100	400
SXTM10060	10 x 60mm	10	60	13	50	10	17	60	350	n/a	50	200
SXTM10075	10 x 75mm		60		50	25				n/a	50	200
SXTM10100-A	10 x 100mm		85		75	25				Option 1	50	200
SXTM10120-A	10 x 120mm		85		75	45				Option 1	50	200
SXTM10140-A	10 x 140mm		85		75	65				Option 1	50	150
SXTM12075	12 x 75mm	12	70	15	60	15	19	80	350	n/a	50	150
SXTM12100-A	12 x 100mm		105		95	5				Option 1	50	75
SXTM12120-A	12 x 120mm		105		95	25				Option 1	25	75
SXTM12150-A	12 x 150mm		105		95	55				Option 1	25	75
SXTM16100	16 x 100mm	16	90	19	80	20	24	100	350	n/a	15	60
SXTM16150	16 x 150mm		90		80	70				n/a	15	60

* Max. power output of impact screw gun | RNSS = ETA Redundant Non Structural System | Option 1 = ETA Option 1 = AS 5216 Compliant



INCLUDES AS5216:2018 COMPLIANT RANGE



Flanged hex head with locking serrations designed to resist loosening and improve dynamic load performance

Asymmetric thread profile provides unparalleled bite in concrete

15 degree thread design provides fast installation and optimum performance

Stamped head for fast and accurate anchor identification

- Diameter
- Length
- ICCONS ID



GALVANISED

ThunderBolt® Pro-XTM Hex Head



Galvanised



NEW

GAL EXTERNAL

	Description	mm	Drill Depth mm	Clearance mm	mm	mm	Socket mm	T _{inst} (Nm)	T _{max} (Nm)	ETA Option	qty	qty
SXTM05050G	5 x 50mm	5	35	7	25	25	8	15	80	n/a	100	800
SXTM06030G	6 x 30mm	6	35	9	25	5	10	20	80	n/a	100	800
SXTM06050G	6 x 50mm		40		30	20				n/a	100	800
SXTM06060G-A	6 x 60mm		65		55	5				RNSS	100	600
SXTM06075G-A	6 x 75mm		65		55	20				RNSS	100	600
SXTM06100G-A	6 x 100mm		65		55	45				RNSS	100	600
SXTM08050G	8 x 50mm	8	50	11	40	10	13	40	185	n/a	100	400
SXTM08060G	8 x 60mm		50		40	20				n/a	100	400
SXTM08075G-A	8 x 75mm		75		65	10				Option 1	100	400
SXTM08100G-A	8 x 100mm		75		65	35				Option 1	100	400
SXTM10060G	10 x 60mm	10	60	13	50	10	17	60	350	n/a	50	200
SXTM10075G	10 x 75mm		60		50	25				n/a	50	200
SXTM10100G-A	10 x 100mm		85		75	25				Option 1	50	200
SXTM10120G-A	10 x 120mm		85		75	45				Option 1	50	200
SXTM10140G-A	10 x 140mm		85		75	65				Option 1	50	150
SXTM10150G-A	10 x 150mm		85		75	75				Option 1	50	150
SXTM12075G	12 x 75mm	12	70	15	60	15	19	80	350	n/a	50	150
SXTM12100G-A	12 x 100mm		105		95	5				Option 1	50	75
SXTM12120G-A	12 x 120mm		105		95	25				Option 1	25	75
SXTM12150G-A	12 x 150mm		105		95	55				Option 1	25	75
SXTM16100G	16 x 100mm	16	90	19	80	20	24	100	350	n/a	15	60
SXTM16150G	16 x 150mm		90		80	70				n/a	15	60

* Max. power output of impact screw gun | RNSS = ETA Redundant Non Structural System | Option 1 = ETA Option 1 = AS 5216 Compliant

SEISMICALLY QUALIFIED FOR USE IN CRACKED CONCRETE



DUSTLESS ANCHORING

The Original **BLUE BANGER HANGER**

For Wood Formed Concrete Decks

ICCONS® Pour-in-Place (PIP) inserts are used on wood form poured decks and installed prior to pouring concrete, reducing installation and material costs.

Machined Steel Insert with Large Flanged Head

- Angled ridges protect the head of the insert from rebar during deck work.
- Larger plastic base ensures that the insert is installed flush to the deck to prevent concrete from contaminating the inner threads during the pour.
- UL plenum rated for use in air handling spaces
- Slurry seal safeguards the internal threads during the concrete pour

Machined Steel Insert with Large Flanged Head and Nails

- Provides excellent shear values for overhead attachments.
- Insert installed height of two inches complies with typical design specifications.
- Nails easily break off.

Multiple Internal Threads

- Reduces inventory, each insert can accommodate M8, M10 & M12 threaded rod sizes.
- Allows for threaded rod size changes after inserts are installed.
- Internal threads eliminate the need and cost of couplings.

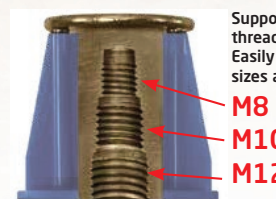

Supports multiple threaded rod sizes. Easily change rod sizes after install.

- M8**
- M10**
- M12**

Large plastic base - ensures that the insert is installed flush to deck to prevent concrete from contaminating the inner threads during the pour and prevents accidental knock-overs

ON WOOD FORM, BEFORE HAMMER BLOW

WOOD FORM REMOVED, AFTER HAMMER BLOW

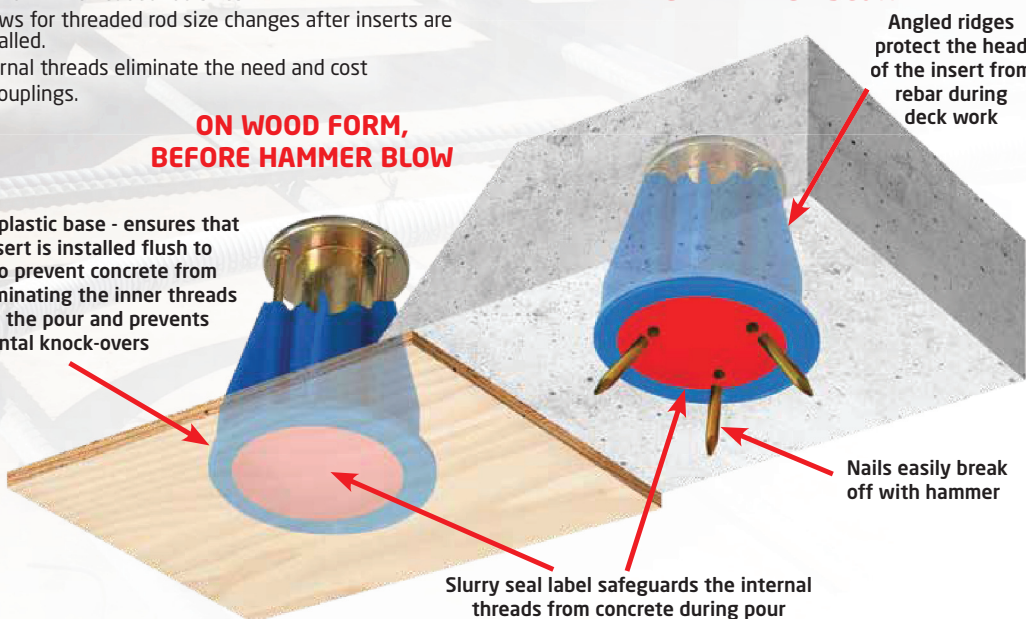

NEW

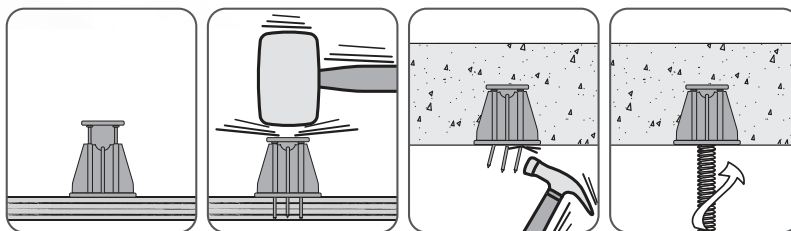

Pour-in-Place Insert - For Wood Form

■ Carbon Steel Zinc Yellow



Part No.	Description	metric	qty
BBPIP081012	Multi Thread Pour-In Place Deck Inserts (for wood form concrete deck)	M8, M10 & M12	100
BBPIP1620	Multi Thread Pour-In Place Deck Inserts (for wood form concrete deck)	M16 & M20	100

NEW

Bazooka PIP Magnetic Installation tool



Ergonomic stand up installation tool

Part No.	Description	qty
BBCEA-PIPINSTALL1	1050mm Bazooka PIP installation tool	1



IPG4 Addendum



ANCHORING

XTM Drop-in Anchor



Carbon Steel Zinc Clear

Stainless Steel 316 A4



NEW

ZINC INTERNAL 316 SS EXTERNAL



Part No.	Part No.	Description	mm	mm	metric	ETA Option	qty	qty
DXTM06		M6 x 25mm Drop-in anchor	8	27	M6	Option 7	100	1000
DXTM08	DXTM08SS	M8 x 30mm Drop-in anchor	10	32	M8	Option 7	100	1000
DXTM10	DXTM10SS	M10 x 40mm Drop-in anchor	12	42	M10	Option 7	50	500
DXTM12	DXTM12SS	M12 x 50mm Drop-in anchor	15	52	M12	Option 7	50	400
DXTMX12		M12 x 50mm Drop-in anchor	16	52	M12	Option 7	50	400
DXTM16	DXTM16SS	M16 x 65mm Drop-in anchor	20	67	M16	Option 7	25	100
DXTM20		M20 x 80mm Drop-in anchor	25	82	M20	Option 7	25	50

XTM Lip Drop-in Anchor



Carbon Steel Zinc Clear

Carbon Steel Zinc Clear Bucket



NEW

ZINC INTERNAL ZINC INTERNAL



Part No.	Part No.	Description	mm	mm	metric	ETA Option	qty	qty
DLXTM1030		M10 x 30mm Lip Drop-in anchor	12	32	M10	Option 7	50	500
	DLXTM1030BK	M10 x 30mm Bucket (1x setting tool 2 x drill bits)				Option 7	500	1000
DLXTM1040		M10 x 40mm Lip Drop-in anchor	12	42	M10	Option 7	50	400
	DLXTM1040BK	M10 x 40mm Bucket (1x setting tool 2 x drill bits)				Option 7	500	1000
DLXTM1225*		M12 x 25mm Lip Drop-in anchor	15	27	M12	n/a	50	300
DLXTM1250		M12 x 50mm Lip Drop-in anchor	15	52	M12	Option 7	50	300
	DLXTM1250BK	M12 x 50mm Bucket (1x setting tool 1 x drill bits)				Option 7	200	400

* DLXTM1225 Not included in assessment

NEW

40mm size with Seismic C1



TOGE TSM IM



Carbon Steel Zinc Grey



COMPLIES WITH AS 5216:2018 FOR POST-INSTALLED FASTENINGS

ZINC INTERNAL



Part No.	Description	mm	mm	mm	metric	qty
TSMIM06040ZG (344106040)	6 x 40 Hanger (M8/M10 internal thread)	12	45	13	M8 /M10	50



ANCHORING



75mm Packing Shims Boxes & Tubs

For Packing around Windows & Doors

Part No.	Part No.	Description	Colour	qty	qty
PKS01575		1.5mm x 75mm White Packer - BOX		100	2400
	PKS01575-TUB	1.5mm x 75mm White Packer - TUB		800	3200
PKS03275		3.2mm x 75mm Blue Packer - BOX		100	1200
	PKS03275-TUB	3.2mm x 75mm Blue Packer - TUB		500	2000
PKS05075		5.0mm x 75mm Red Packer - BOX		100	800
	PKS05075-TUB	5.0mm x 75mm Red Packer - TUB		400	1600
PKS06475		6.4mm x 75mm Green Packer - BOX		100	800
	PKS06475-TUB	6.4mm x 75mm Green Packer - TUB		300	1200
PKS10075		10.0mm x 75mm Black Packer - BOX		100	600
	PKS10075-TUB	10.0mm x 75mm Black Packer - TUB		200	800



75mm Packing Shims Mixed Tub

For Packing around Windows & Doors

Part No.	Description		Colour	qty	qty
PKSMIX-TUB	1.5mm x 75mm White Packer	150 x White Packing Shims per tub		1 Tub (400pce)	4 x Tubs (1600pce)
	3.2mm x 75mm Blue Packer	90 x Blue Packing Shims per tub			
	5.0mm x 75mm Red Packer	90 x Red Packing Shims per tub			
	6.4mm x 75mm Green Packer	20 x Green Packing Shims per tub			
	10.0mm x 75mm Black Packer	50 x Black Packing Shims per tub			



90mm Packing Shims Tubs

For Packing around Windows & Doors

NEW

Part No.	Description		Colour	qty	qty
PKS01090-TUB	1.0mm x 90mm Brown Packer - TUB			900	3600
PKS01590-TUB	1.5mm x 90mm White Packer - TUB			600	2400
PKS02090-TUB	2.0mm x 90mm Grey Packer - TUB			500	2000
PKS03090-TUB	3.0mm x 90mm Blue Packer - TUB			350	1400
PKS05090-TUB	5.0mm x 90mm Red Packer - TUB			250	1000
PKS10090-TUB	10.0mm x 90mm Black Packer - TUB			150	600

TOGGLEBITE

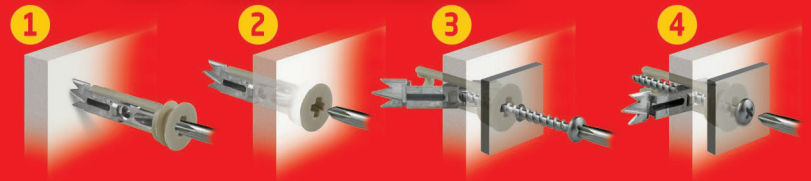
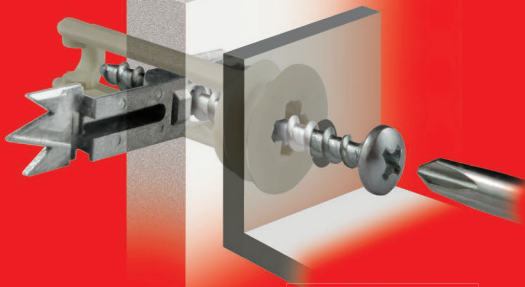

1 Insert the point of a #2 Phillips Head screwdriver into the recess of the **ICCONS TOGGLE BITE**, place the drill point against the wall to lightly pierce the plasterboard.

2 Screw **TOGGLE BITE** into the plasterboard until the head is flush with the surface.

3 Position fixture, insert screw, turn screw to engage the toggle behind the wall.

4 Continue to turn the screw until the fixture is pulled against the plasterboard.



NEW

Toggle-Bites - With Screw

Drill Point Nylon / Alloy Toggle-Bite

Unique Drill Point for easy, clean and precise installs.

ICCONS® TOGGLE BITE features a movable alloy toggle that allows the anchor to clamp the plasterboard for added strength.

- Self drilling anchor for heavy duty, vibration resistant plasterboard fixing.
- Ideal for fixing shelving brackets, mirrors, cabinets, curtain rods, pictures, fire extinguishers, hanging plants, lighting fixtures, coat hooks, etc. into plasterboard.
- Can be used for wall or ceiling mounts.
- Maximum recommended load - Plasterboard 20KG



NYLON



Part No.	Description	Ph2	Hang Pack	Counter display
PBTBNYLON-WS	Self drilling wall toggle for plasterboard with pan head screw		25pce	500 (20 x 25pce)

THE BETTER BIT

Countersink Tool For Fibre Cement Compressed Sheet

The BETTER-Bit Pre-drilling and Countersinking Tool is designed for fibre cement compress sheet. Features dual function stop collar with engineered "O" ring to protect the work surface, and replaceable long-life drill bits that efficiently cut through F.C Compressed sheet.



For Fibre Cement



Features:

- DUAL ACTION TWIN LOW FRICTION SPIN BEARINGS
- SUITABLE FOR IMPACT DRIVERS OR DRILL DRIVERS
- ENGINEERED "O"RING TO PROTECT THE WORK SURFACE

NEW



Part No.	Description	gauge	Blister	qty
TBBFC10G	Countersinking Tool for 10g screws - Fibre Cement compressed sheet	10g	1	6

X3

SPECIAL SCREW

the increased minor diameter guarantees high loading capacity with safe installation even on cracked concrete. The rounded geometry of the thread, designed to prevent internal damage to the nylon plug, increases the expansion and the adhesion of the plug in the base material.



INCREASED EXPANSION

the screw and plug cooperate actively creating an innovative expansion with variable geometry that guarantees exceptional pull-out even in hollow base materials or in the presence of irregular holes.

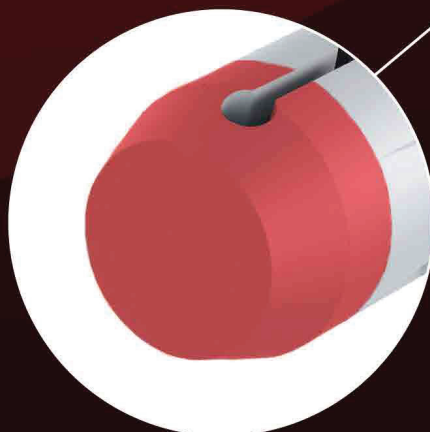
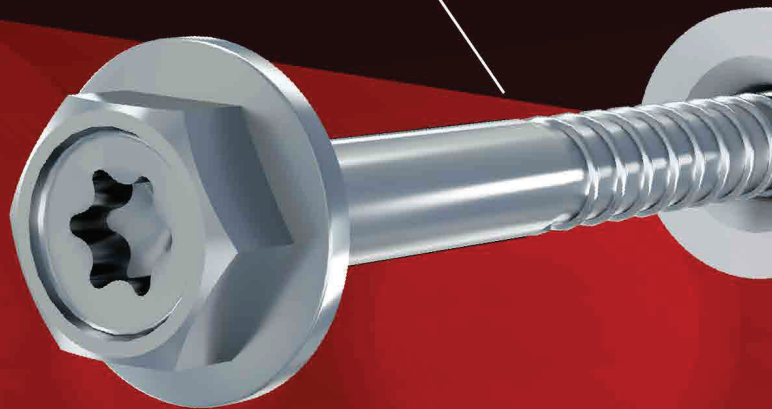

DYNAMIC TIP

the closed end and the conical shape facilitate insertion into the hole. During expansion, the special internal geometry generates a strong additional expansion which further increases resistance to extraction.

**MAXI LONGITUDINAL
ANTIROTATION WINGS**

along the plug ensure a correct installation preventing plug rotation.

**UNDERHEAD WINGS**

guarantee the adhesion of the plug to the element to be fixed.

**LARGE RIM**

for the fixing of metal structures. The large rim version is designed to prevent corrosion from contact between the bracket and the screw.

**UP TO THREE
EMBEDMENT DEPTHS**

the variable installation ensures great versatility of use, a single plug for multiple applications. The reduced embedment depth allows maximum saving in drilling and installation time.



X3

THE NEW HIGH PERFORMANCE LONG PLUG

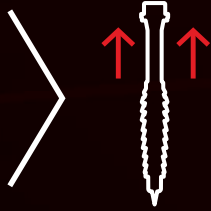

**MAXIMUM
PULL-OUT VALUES**
EXTRAORDINARY
PERFORMANCE ON
ALL BASE MATERIALS

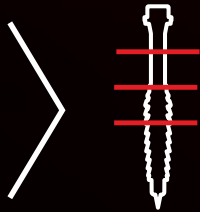

**UP TO THREE
EMBEDMENT DEPTHS**
EXTREME VERSATILITY AND
SIGNIFICANT REDUCTION IN
INSTALLATION TIME

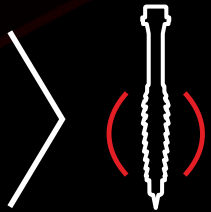

**INCREASED
EXPANSION**
DESIGNED FOR
FACADES AND
HEAVY CARPENTRY

**MAXIMUM
PULL-OUT
VALUES**

**UP TO
2.000
Kg***

FRIULSIDER
YOUR FIXING FACTORY



ANCHORING



FRIULSIDER X3
YOUR FIXING FACTORY



Nylon Frame Fixing - Collared

Carbon Steel Zinc Clear Hex Head Screw w/ flanged Plug

Carbon Steel Galvanised Hex Head Screw w/ flanged Plug



Stainless Steel 316 A4 Hex Head Screw w/ flanged Plug

NEW

Part No.	Part No.	Part No.	Description	mm	mm	mm	head	mm	qty	qty
FMX3TH10060 (64703b10060)	FMX3TH10060G (64703c10060)		10 x 60mm	10	50	10	Hex with internal T40	7 x 68	50	500
FMX3TH10080 (64703b10080n6)	FMX3TH10080G (64703c10080n6)	FMX3TH10080SS (64703010080n6)	10 x 80mm	10	50	30	Hex with internal T40	7 x 88	50	500
FMX3TH10100 (64703b10100n6)	FMX3TH10100G (64703c10100n6)	FMX3TH10100SS (64703010100n6)	10 x 100mm	10	50	50	Hex with internal T40	7 x 108	50	500
FMX3TH10120 (64703b10120n6)	FMX3TH10120G (64703c10120n6)	FMX3TH10120SS (64703010120n6)	10 x 120mm	10	50	70	Hex with internal T40	7 x 128	50	500
FMX3TH10140 (64703b10140n6)	FMX3TH10140G (64703c10140n6)	FMX3TH10140SS (64703010140n6)	10 x 140mm	10	50	90	Hex with internal T40	7 x 148	50	500
		FMX3TH10160SS (64703010160n6)	10 x 160mm	10	50	110	Hex with internal T40	7 x 168	50	500

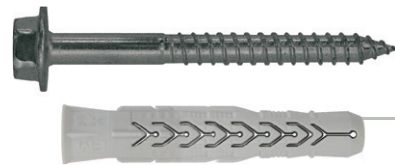

FRIULSIDER X3
YOUR FIXING FACTORY



Nylon Frame Fixing - Non Collared

Carbon Steel Galvanised Hex Head Screw w/ flanged Plug

NEW

Part No.	Description	mm	mm	mm	head	mm	qty	qty
FMX3THNF10060G (64603c10060)	10 x 60mm	10	50	10	Hex with internal T40	7 x 90	50	500

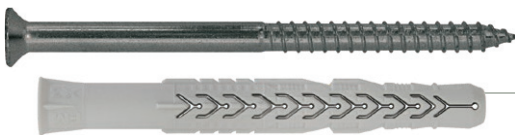

FRIULSIDER X3
YOUR FIXING FACTORY



Nylon Frame Fixing - Non Collared

Carbon Steel Galvanised Countersunk

NEW

Part No.	Description	mm	mm	mm	head	mm	qty	qty
FMX3C10060G (64602c10060n6)	10 x 60mm	10	50	10	Hex with internal T40	7 x 68	50	500
FMX3C10080G (64602c10080n6)	10 x 80mm	10	50	30	Hex with internal T40	7 x 88	50	500
FMX3C10100G (64602c10100n6)	10 x 100mm	10	50	50	Hex with internal T40	7 x 108	50	500
FMX3C10120G (64602c10120n6)	10 x 120mm	10	50	70	Hex with internal T40	7 x 128	50	500
FMX3C10140G (64602c10140n6)	10 x 140mm	10	50	90	Hex with internal T40	7 x 148	50	500
FMX3C10160G (64602c10160n6)	10 x 160mm	10	50	110	Hex with internal T40	7 x 168	50	500

**NEXT
GEN
ADHESIVES**

ICCONS®
Serious Connections®

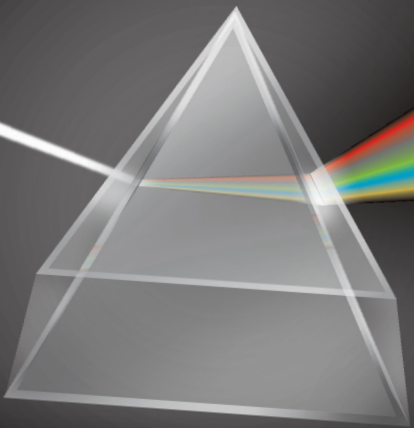

We've got the full spectrum of NEXT GEN adhesive solutions



Pure Epoxy
Hybrid
Vinylester
Polyester
Capsules

- Highest International Assessment and National Code Compliant Adhesives
- Easy select colour range - Red, Platinum, Green, Blue & Gold
- Clear, easy to understand labelling
- Cracked Concrete and Seismic Solutions
- 100 Year Design Life Adhesive





CHEMSELECT



CHEMSELECT



CHEMSELECT



CHEMSELECT



CHEMSELECT

CODE RED 440mL or 1400mL**BIS-PE GEN3****100 Year Design Life****Dustless drilling****Assessed for use in cracked concrete****Extreme strength load performance****30 min working (gel) time @ 20°C dry concrete****Perfect in Rebar****Perfect for threaded studs and inserts****Assessed for core drilled holes****Suitable for water flooded holes**

When it's RED it's Pure Epoxy.

ICCONS® BIS-PE GEN3 is the ultimate 3:1 High Performance Pure Epoxy with 100 Years Design Life in accordance with EAD 330499-01-0601.

BIS-PE GEN3 is the ultimate choice for Threaded rod, Rebar and Threaded Inserts in Cracked or Non-Cracked Concrete.

ETA assessed for use in Diamond Core Drilled holes, C1 & C2 Seismic applications and 100 Year Design Life applications on road, tunnel and infrastructure projects.

**CODE RED** 385mL or 585mL**BIS-PE**
Pure Epoxy**Assessed for use in cracked concrete****Extreme strength load performance****30 min working (gel) time @ 20°C dry concrete****Perfect in Rebar****Perfect for threaded studs and inserts****Assessed for core drilled holes****Suitable for water flooded holes**

When it's RED it's Pure Epoxy.

ICCONS® BIS-PE is the superior 3:1 High Performance Pure Epoxy.

BIS-PE is the ultimate choice for Threaded rod & Rebar in Cracked or Non-Cracked Concrete.

Assessed for use in Diamond Core Drilled Holes, C1/C2 Seismic and Roads Applications.

**CODE PLATINUM** 280mL or 420mL**BIS-HY**
Hybrid
GEN2**Hybrid**
GEN2**Dustless drilling****Assessed for use in cracked concrete****Extreme strength load performance****30 min rapid cure time @ 20°C dry concrete****Perfect in Rebar****Perfect for threaded studs and inserts****Suitable for water flooded holes**

When it's PLATINUM it's Hybrid.

Combining the superior strength of Epoxy with a fast cure vinyl ester. Fire Rating F120 (2 hours) and assessed for use in temperatures up to 160°C. ICCONS® BIS-HY is a rapid cure, styrene free, non-sag, extreme performance Hybrid Injection Adhesive. BIS-HY is suitable for Threaded Rod and Rebar in cracked and non-cracked concrete and Australia's first rapid cure with Seismic C2 assessment for threaded rod.



ETA Network - Cracked Concrete - Seismic C1/C2 - Fibre Reinforced Polymer - Fire Retardant



ADHESIVES

CHEMSELECT CHEMSELECT CHEMSELECT CHEMSELECT CHEMSELECT CHEMSELECT

CODE RED

B+BTEC BIS-PE GEN3 Injection

Pure Epoxy GEN3 - EXTREME STRENGTH



100+

YEAR DESIGN LIFE



Pure-Epoxy GEN3

When it's RED it's Pure Epoxy.

ICCONS® BIS-PE GEN3 is the ultimate 3:1 High Performance Pure Epoxy with 100 Years Design Life in accordance with EAD 330499-01-0601.

BIS-PE GEN3 is the ultimate choice for Threaded rod, Rebar and Threaded Inserts in Cracked or Non-Cracked Concrete. ETA assessed for use in Diamond Core Drilled holes, C1 & C2 Seismic applications and 100 Year Design Life applications on road, tunnel and infrastructure projects.

- Potable water approval

Concrete Temperature	Processing time	Curing Time	
		Dry Holes	Wet Holes
+5°C to +9°C	80 min	48 h	96 h
+10°C to +14°C	60 min	28h	56 h
+15°C to +19°C	40 min	18 h	36 h
+20°C to +24°C	30 min	12 h	24 h
+25°C to +34°C	12 min	9 h	18 h
+35°C to +39°C	8 min	6 h	12 h
+40°C	8 min	4 h	8 h

NEW

COMPLIES WITH
AS 5216:2018
FOR
POST-INSTALLED
FASTENINGS

How Much Adhesive Do You Need?
Work It Out On The ICCONS® App!

Available on the App Store | GET IT ON Google Play

Part No.	Description	qty	qty
BIS-PE GEN3 -440	440ml injection cartridge includes 2 x mixer nozzles	2	12
BIS-PE GEN3 -1400	1400ml injection cartridge includes 2 x mixer nozzles (pneumatic tool required for 1400ml system)	1	5



NO HOLE CLEANING REQUIRED!

ETA Assessment for use with ICCONS/Heller duster expert hollow drill bits (and class M Vacuum), refer to ICCONS Technical data sheet for further details



Load Performance
EXTREME



Working Time
30 mins



Curing Time
10 hours



Wet Holes



Water Filled Holes



Core Drilled Holes



Overhead



Masonry /
Brickwork



Rebar



Threaded Studs



Threaded Inserts



Fire Rated



ETA
Cracked
Concrete



C1 & C2
Seismic
Approval



Green
Projects -
LOW VOC



National Code
Compliant



CODE PLATINUM

B+BTEC BIS-HY GEN2 Injection

Hybrid GEN2- EXTREME STRENGTH



Hybrid GEN2

When it's PLATINUM it's Hybrid

Combining the superior strength of Epoxy with a fast cure vinylester. Fire Rating F120 (2 hours) and assessed for use in temperatures up to 160°C. ICCONS® BIS-HY GEN2 is a rapid cure, styrene free, non-sag, extreme performance Hybrid Injection Adhesive.

BIS-HY Gen 2 is suitable for Threaded Rod and Rebar in cracked and non-cracked concrete and Australia's first rapid cure with Seismic C2 assessment for threaded rod.

- Main Roads (QLD TMR) Approved
- Potable water approval

Concrete Temperature	Processing time	Curing Time	
		Dry Holes	Wet Holes
-5°C to -1°C	50 min	5 h	10 h
0°C to +4°C	25 min	3.5 h	7 h
+5°C to +9°C	15 min	2 h	4 h
+10°C to +14°C	10 min	1 h	2 h
+15°C to +19°C	6 min	40 min	1 h
+20°C to +29°C	3 min	30 min	1 h
+30°C to +40°C	2 min	30 min	1 h

NEW



How Much Adhesive Do You Need? Work It Out On The ICCONS® App!

COMPLIES WITH AS 5216:2018 FOR POST-INSTALLED FASTENINGS

Part No.	Description	qty	qty
BIS-HYGEN2 -420	420ml Injection Cartridge includes 2 x mixer nozzles	1	12
CNOZ10-HY	Mixer Nozzle for BIS-HY Gen2 Hybrid (Pack of 10)	10 pack	n/a



NO HOLE CLEANING REQUIRED!

ETA Assessment for use with ICCONS/Heller duster expert hollow drill bits (and class M Vacuum), refer to ICCONS Technical data sheet for further details



Load Performance EXTREME



Working Time 3 mins



Curing Time 30 mins



Wet Holes



Water Filled Holes



Overhead



Masonry / Brickwork



Rebar



Threaded Studs



Threaded Inserts



Fire Rated



ETA Approval



ETA Cracked Concrete



C1 & C2 Seismic Approval



Green Projects - LOW VOC



National Code Compliant

FASTER, EASIER AND MORE RELIABLE THAN EVER

ICCONS NEW XTREME CONCRETE NAILER

GT-6 IXF

Gas fastening systems are now utilised by many construction professionals for a wide range of applications as they are fast and easy to use.

- Simple fuel cell hook up with NEW fuel cell door design
- NEW narrow nose piece design prevents collation trapping
- Strong 95 joules of xtreme power
- Light weight 3.76 kg
- Perfectly positioned belt hook for evenly balanced movement
- Simple pin depth adjustment
- 2 x lithium ion batteries

LITHIUM
Long Life **E-ION**





Strong 95 joules of power

New Fuel Cell Door design for simple Fuel Cell hook up

Evenly balanced with well positioned **Belt Hook.**

2 x Lithium Ion batteries

LITHIUM Long Life ION

Kit includes GT-6 IXF tool, charger, 2 x Li-Ion batteries, safety glasses & instruction booklet

Light 3.76 kg weight

NEW Narrow Nose design prevents collation getting trapped when overhead

Simple quick twist **Pin Depth Adjuster**

Choose between **Long Track** or **Short Track** capacity

Direct Fixing of metal stud partitioning, furring channel clips, fire rated angle clips.

Direct fixing of waterproofing and termite barriers with pin & metal washer combinations

Electrical & Plumbing installations for Conduits or Hot & Cold Pex pipe combined with Apollo quick clips and cable tie mounts



NEW

GT-6IXF Gas Tool

Long & Short Track



Part No.	Description	qty
GT-6IXF	Long track (40 pin capacity) - Kit includes GT-6IXF tool, charger, 2 x Li-Ion batteries, safety glasses & instruction booklet	1
GT-6IXF-ST	Short track (30 pin capacity) - Kit includes GT-6IXF-ST tool, charger, 2 x Li-Ion batteries, safety glasses & instruction booklet	1



COMPACT

Insulation Fastening Tool

For Fastening Rigid Board &
Soft Insulation Board To Concrete

LIGHTER

QUIETER

FASTER

SAFER

POWERFUL



GTIXF-160C



NEW

GTIXF-160C Insulation Gas Tool

Compact Gas Operated tool for installing insulation washers

FEATURES

- For all types of insulation fixing
- Quick and easy insulation fixing
- Fixing on hollow brick without damage to the base material
- PAT replacement
- Durable Fuel Cell



Part No.	Description	qty
GTIXF-160C	Compact Insulation Tool - Kit includes GTIXF-160C tool, charger, 2 x batteries, safety glasses & instruction booklet	1



GTIXF-160C Insulation Fasteners

For GTI-140C & GTIXF-160C Gas nailers

Not suitable for fire rated applications.

WHITE	BLACK	GREY					
Part No.	Part No.	Part No.	Description	mm	mm	qty	qty
GTIF025	GTIFB025		For 25mm insulation	25	60	50	1000
GTIF030			For 30mm insulation	30	60	50	1000
GTIF035			For 35mm insulation	35	60	50	1000
GTIF040	GTIFB040		For 40mm insulation	40	60	50	1000
GTIF050		GTIFG050 NEW	For 50mm insulation	50	60	50	900
GTIF060			For 60mm insulation	60	60	50	800
GTIF075	GTIFB075		For 75mm insulation	75	60	50	600
GTIF080			For 80mm insulation	80	60	50	600
GTIF090			For 90mm insulation	90	60	50	600
GTIF100			For 100mm insulation	100	60	25	500
GTIF120			For 120mm insulation	120	60	25	400

Not suitable for fire rated applications. Other sizes available on request.

GRIPSHANK™ SUPERSHARPY™ NAILS



RECOMMENDED APPLICATIONS:

- Flooring installation
- Plated lintels
- Batten installation (Wall Cavity, Ceiling and Roof)
- Bracing sheet installation
- Lightweight Cladding Systems

RECOMMENDED TOOL:

SNTJN65

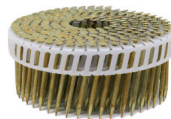

GRIPSHANK™ SUPERSHARPY™

1060
CARBON
STEEL



Part No.	Description	mm	mm	mm	mm	qty	qty
SNC2359NG	Gripshank™ Supersharpy™ 38x2.5	0.4 - 2.5	38	2.5	6.4	3200	n/a
SNC2509NG	Gripshank™ Supersharpy™ 50x2.5	0.4 - 2.5	50	2.5	6.4	2400	n/a
SNC2639NG	Gripshank™ Supersharpy™ 63x2.5	0.4 - 2.5	63	2.5	6.4	2400	n/a

Note: Visit www.iccons.com.au and download the Structnail document for specification data



COIL NAILER

SNTJN65

FOR PLATING, CLADDING & FLOORING

- Plastic collation
- 38-65mm nail range
- 200 nail load capacity
- 70-120 Psi operation
- Depth adjustment
- Single fire
- 2.5kg



RECOMMENDED APPLICATIONS:

- Flooring installation
- Plated lintels
- Batten installation (Wall Cavity, Ceiling and Roof)
- Bracing sheet installation
- Lightweight Cladding Systems

RECOMMENDED NAILS:

Gripshank™ Supersharpy™



GTMA-25W



SNW25G

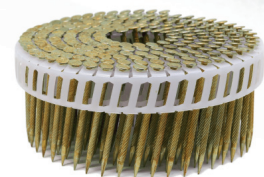

15° COIL NAILER

Part No.	Description	qty	qty
SNTJN65	15° Coil Nailer	1	n/a
GTMA-25W	Magnetic Adaptor for use with 25mm O.D metal washer	1	n/a
SNW25G	25mm O.D Metal Washer Galvanised (use with GTMA-25W)	250	5000

TRIM BRADS

15 GAUGE HARDENED



RECOMMENDED APPLICATIONS:

- Door jambs
- Architraves
- Skirting

RECOMMENDED TOOL:

SNTST1850C4



TRIM 15 GAUGE HARDENED BRADS

Part No.	Description	 mm	 mm	 gauge	 qty	 qty
SNS075-100T	Trim Brad 25x15g	0.4 - 3.0	25	15g	3000	30000
SNS075-150T	Trim Brad 38x15g	0.4 - 3.0	38	15g	1500	15000
SNS1200 Finish	Trim Brad 50x15g	0.4 - 3.0	50	15g	1500	15000

Note: 15 Gauge = 15 Pins per inch



TRIM BRADDER

SNTST1850C4

TRIM TO STEEL

Aerosmith™ Trim Brads

25-50mm brad range

60 brad load capacity

70-110 Psi operation

Trigger safety lock

Single fire

1.29kg



RECOMMENDED APPLICATIONS:

- Door jambs
- Architraves
- Skirting

RECOMMENDED BRADS:

Trim Hardened Brad 15 Gauge

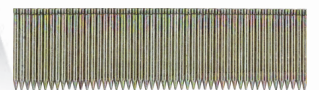

15 GAUGE TRIM BRADDER



Part No.	Description	qty	qty
SNTST1850C4	Trim Bradder	1	n/a

STEEL CHASSIS PIN

HEAVY DUTY



RECOMMENDED APPLICATIONS:

- Modular flooring
- Steel Subfloors
- Mezzanine Floors
- Timber, Ply and CFC Flooring Materials







RECOMMENDED TOOL:

SNTCT9011



STEEL CHASSIS PIN

1060
CARBON
STEEL

Part No.	Description	 mm	 mm	 mm	 mm	 qty	 qty
SNS5454PG	Steel Chassis Pin with PT2000® Coating	0.95-4.0mm	45	3.6	7.6	3200	n/a



HEAVY FLOOR NAILER

SNTCT9011

FIXING TO HEAVY STEEL

- Heavy Floor Nailer
- Steel Chassis Pins
- 19-64mm pin range
- 60 pin load capacity
- 110-150 Psi operation
- Single fire
- 5.0kg



RECOMMENDED APPLICATIONS:

- Modular flooring
- Steel Subfloors
- Mezzanine Floors
- Timber, Ply and CFC Flooring Materials

RECOMMENDED PIN:

Steel Chassis Pin



HEAVY STEEL NAILER

Part No.	Description	 qty	 qty
SNTCT9011	Heavy Steel Nailer	1	n/a

ROOF & CLADDING SCREWS

RoofStars® & RoofStarPro™



NEW RoofStarPro™

Corrugated Sheet to Metal Battens

- Intelligent design for fixing of corrugated Steel roof sheet to metal battens up to 1.9mm.
- Super fast
- Great Value
- High performance
- Available in the Colorbond® colour range
- 70% Australian made - Galvanising, Deks® washer, painting, assembly & packaging all carried out in Australia

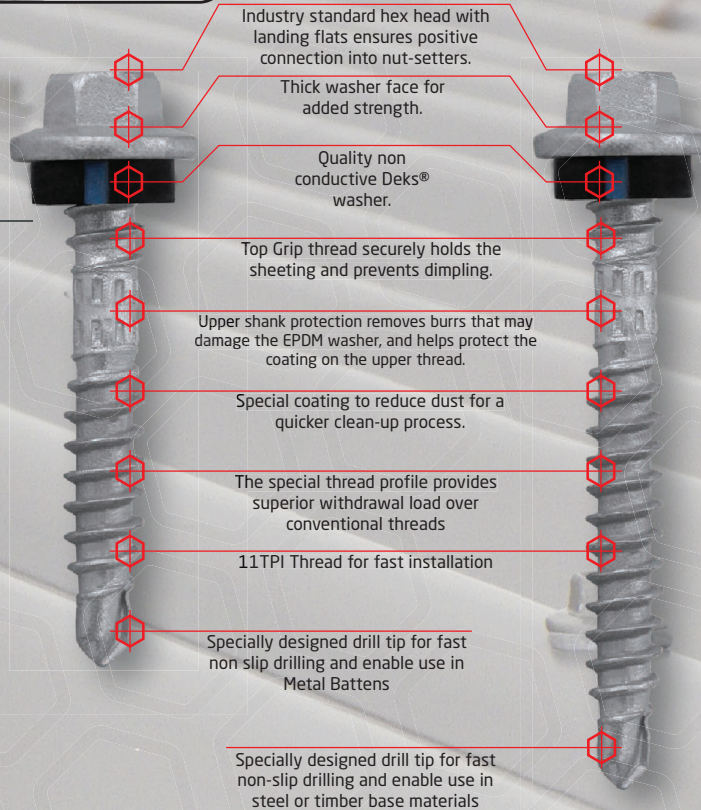

RoofStars®

Metal Roof Sheet to Steel or Timber Battens

- Self-drilling universal roofing screw with sealing washer
- Fastening metal roof sheet to thin metal battens, steel purlins up to 1.9mm
- Can be used to fasten to timber battens.
- Super fast
- Great Value
- High performance
- Available in the Colorbond® colour range.
- 70% Australian made - Galvanising, Deks® washer, painting, assembly & packaging all carried out in Australia

NAUTILUS® IIXTEND®

IC4 EXTERNAL

IC Find #	Part No.	Description	mm	mm	Thread /mm	qty	qty
NEW 161W	SDHXUNI1338C4W	13-11 X 38 Corrugated profile to metal battens	Hex 5/16	0.55 - 1.90	18	1000	1000
162W*	SDHXUNI1350C4W	13-11 X 50 Metal roof to metal battens & timber	Hex 5/16	0.55 - 1.90	33	1000	1000

* Available in TRADE PACK



- Non - magnetic
- No more wobbly installs from swarf build up
- Pressure fit holds the screw firmly in place via 3 ball bearings & spring clip
- Ideal for Stainless Steel & Carbon Steel fasteners
- Impact Rated
- Great choice for Roofing Screws

VISIT WWW.ICCONS.COM.AU
To view the new FASTDRIVE power tool accessories range

ICCONS® PRESSURE FIT NON-MAGNETIC NUT-SETTERS ARE THE WAY TO GO....

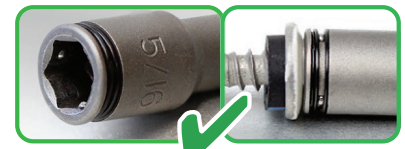

MAGNETIC BITS OFTEN CAUSE POOR FITTING &/OR WOBBLY INSTALLS FROM SWARF BUILD UP.





NEW
Ideal for concealed clips
in roofing applications!

Self Drilling Hex Head Reduced Head

■ 12 Gauge with 10 gauge head - Category 3

NAUTILUS® 3

IC Find #	Part No.	Description	mm	mm	Thread /mm	qty	qty
121	SDHXC10-12030C3	12-14 x 30	5/16	1.00 - 4.50	Full	500	1500

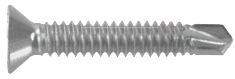

NEW

Self Drilling CSK Head

■ 10 Gauge - Fine Thread - Category 3

NAUTILUS® 3

IC Find #	Part No.	Description	mm	mm	Thread /mm	qty	qty
303	SDCSF1030C3	10-24 x 30	CSK / PH2	1.20 - 3.50	Full	1000	4000
305	SDCSF1040C3	10-24 x 40	CSK / PH2	1.20 - 3.50	Full	1000	3000
307	SDCSF1050C3	10-24 x 50	CSK / PH2	1.20 - 3.50	Full	500	2000
309	SDCSF1065C3	10-24 x 65	CSK / PH2	1.20 - 3.50	Full	500	1500



NEW

Needle Point Button Head

■ 8 Gauge - Category 3

NAUTILUS® 3

IC Find #	Part No.	Description	mm	mm	Thread /mm	qty	qty
810	NPBH0815C3	8-15 x 15	PH2	0.5 - 0.75	Full	1000	6000

5 Series

- For Fastening Into Thick Steel
- FASTER DRILLING
- EASY PENETRATION
- SUPERIOR SWARF EJECTION
- LOW FORCE

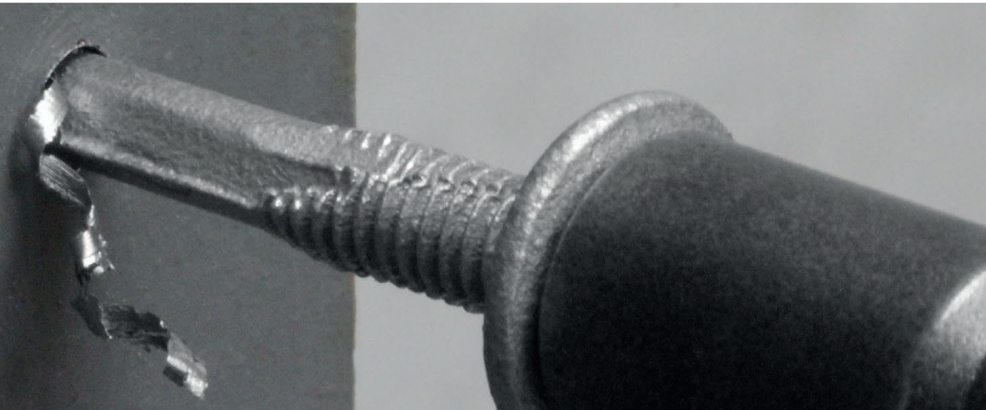

Self Drilling Wafer Head - 5 Series

NAUTILUS® 3

IC Find #	Part No.	Description	mm	mm	Thread /mm	qty	qty
410	SDWA5F1232C3	12-24 x 32	Wafer / PH3	3.00 - 12.00	Full	500	1500
412	SDWA5F1250C3	12-24 x 50	Wafer / PH3	3.00 - 12.00	Full	1000	1000

NEW



Self Drilling Countersunk Head - 5 Series

NAUTILUS® 3

IC Find #	Part No.	Description	mm	mm	Thread /mm	qty	qty
414	SDCS5F1232C3	12-24 x 32	CSK / PH3	3.00 - 12.00	Full	500	1500
415	SDCS5F1238C3	12-24 x 38	CSK / PH3	3.00 - 12.00	Full	500	1500
416	SDCS5F1250C3	12-24 x 50	CSK / PH3	3.00 - 12.00	Full	1000	1000
418	SDCS5F1265C3	12-24 x 65	CSK / PH3	3.00 - 12.00	Full	1000	1000

NEW

SELF DRILLING



S-TET Aesthetic Architectural Tamper Resistant Screw

The S-TET has a discreet, aesthetic, extra-flat head design and is finished in Nautilus-4 C4 corrosion resistant coating. S-TET screws are available in multiple colours to suit your design. S-TET accentuates the aesthetics of building façades.

A meeting of innovation and know-how, the new European designed S-TET self-drilling screw meets the requirements of Architects & Designers who want a simple and pleasing aesthetic look as well as offering a tamper resistant solution.

S-TET European design harmonizes with the aesthetic constraints of modern architecture and security.



Suitable Applications:

Aesthetics

- Prestigious Cladding
- Façade Applications

Security

- Correctional Services Facilities
- Fencing
- Industrial Warehouse Cladding

Safety

- Pool Fencing
- School Perimeter Fencing
- Child Care Facilities
- Aged Care Facilities



ICCONS S-TET Aesthetic Architectural Tamper Resistant Screws are available in a wide range of custom and Colorbond® colours.

Contact ICCONS for availability and lead times.

BA BASALT®	CC CLASSIC CREAM™	CG COTTAGE GREEN®	CO COVE™	DO DEEP OCEAN®
DU DUNE®	EH EVENING HAZE®	GU GULLY™	MR MANOR RED®	IS IRONSTONE®
JA JASPER®	LO LOFT®	MA MANGROVE®	MO MONUMENT®	NS NIGHT SKY®
PA PAPERBARK®	PE PALE EUCALYPT®	SA SANDBANK®	SG SHALE GREY™	SM SURF MIST®
TE TERRAIN®	WA WALLABY®	WG WOODLAND GREY®	WI WILDERNESS®	WS WINDSPRAY®



STET Aesthetic Architectural Tamper Resistant Screw - Coarse Thread Flat Head



■ 12 Gauge - Coarse Thread - Category 4

■ 12 Gauge - Coarse Thread - with A12 washer Category 4



NEW **FRIULSIDER**
YOUR FIXING FACTORY



IC4 EXTERNAL

IC4 EXTERNAL with A12 washer

IC Find #	Part No.	IC Find #	Part No.	Description	mm	mm	Thread /mm	qty	qty
470	SDTETFH12025C4	470W	SDTETFH12025C4W	12-18 x 25	STET Tool	1.50 - 4.00	Full	500	2000
472	SDTETFH12032C4	472W	SDTETFH12032C4W	12-18 x 32	STET Tool	2.00 - 6.00	Full	400	1600

STET Aesthetic Architectural Tamper Resistant Screw - 5 Series Flat Head



■ 12 Gauge - Fine Thread -5 Series - Category 4

■ 12 Gauge - Fine Thread -5 Series- with A12 washer Category 4



NEW **FRIULSIDER**
YOUR FIXING FACTORY



IC4 EXTERNAL

IC4 EXTERNAL with A12 washer

IC Find #	Part No.	IC Find #	Part No.	Description	mm	mm	Thread /mm	qty	qty
490	SDTETFH5F12038C4	490W	SDTETFH5F12038C4W	12-18 x 38	STET Tool	4.00 - 12mm	Full	250	1000

STET Clamping Socket Driver

For use with STET Screws

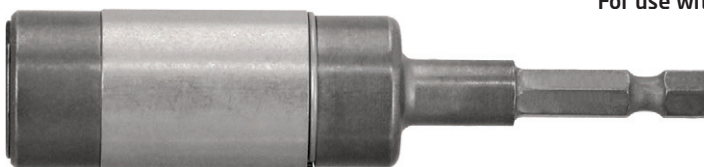

NEW



Part No.	Description	qty
SD-TET-TOOL	Special tool for STET Screws (1/4" drive)	1



heller ENDURO SDS MAX Trijet 12-16mm sizes



Part No.	Description		mm	qty	mm	qty
HMAX12-340	12 x 340mm (28178 2)		12	340	200	1
HMAX12-540	12 x 540mm (28179 9)		12	540	400	1
HMAX14-340	14 x 340mm (28183 6)		14	340	200	1
HMAX14-540	14 x 540mm (28184 3)		14	540	400	1
HMAX16-340	16 x 340mm (28188 1)		16	340	200	1
HMAX16-540	16 x 540mm (28189 8)		16	540	400	1
HMAX16-940	16 x 940mm (28191 1)		16	940	800	1
HMAX16-1340	16 x 1340mm (28192 8)	NEW	16	1340	1200	1



heller ENDURO SDS MAX Y Cutter 18-30mm sizes



Part No.	Description		mm	qty	mm	qty
HMAX18-340	18 x 340mm (22363 8)		18	340	200	1
HMAX18-540	18 x 540mm (22364 5)		18	540	400	1
HMAX20-320	20 x 320mm (22365 2)		20	320	200	1
HMAX20-520	20 x 520mm (22366 9)		20	520	400	1
HMAX20-720	20 x 720mm (28194 2)		20	720	600	1
HMAX20-920	20 x 920mm (22367 5)	NEW	20	920	800	1
HMAX22-320	22 x 320mm (22368 3)		22	320	200	1
HMAX22-520	22 x 520mm (22369 0)		22	520	400	1
HMAX24-320	24 x 320mm (22371 3)		24	320	200	1
HMAX24-520	24 x 520mm (22372 0)		24	520	400	1
HMAX25-520	25 x 520mm (22374 4)		25	520	400	1
HMAX25-920	25 x 920mm (22375 1)		25	920	800	1
HMAX26-340	26 x 340mm (23113 8)		26	340	200	1
HMAX26-520	26 x 520mm (23114 5)		26	520	400	1
HMAX28-340	28 x 340mm (22377 5)		28	340	200	1
HMAX28-520	28 x 520mm (22378 2)		28	520	400	1
HMAX30-320	30 x 320mm (22380 5)	NEW	30	320	200	1
HMAX30-520	30 x 520mm (22381 2)		30	520	400	1
HMAX32-320	32 x 320mm (22382 9)	NEW	32	320	200	1
HMAX32-520	32 x 520mm (22383 6)	NEW	32	520	400	1
HMAX32-720	32 x 720mm (28199 7)	NEW	32	720	600	1
HMAX35-320	35 x 320mm (22386 7)	NEW	35	320	200	1
HMAX35-520	35 x 520mm (22387 4)		35	520	400	1
HMAX35-720	35 x 720mm (22388 1)	NEW	35	720	600	1
HMAX38-320	38 x 320mm (22389 8)	NEW	38	320	200	1
HMAX38-520	38 x 520mm (22390 4)		38	520	400	1
HMAX38-720	38 x 720mm (28200 0)	NEW	38	720	600	1
HMAX40-320	40 x 320mm (22391 1)	NEW	40	320	200	1
HMAX40-520	40 x 520mm (22392 8)		40	520	400	1
HMAX40-720	40 x 720mm (28201 7)	NEW	40	720	600	1
HMAX40-920	40 x 920mm (22393 5)	NEW	40	920	800	1
HMAX40-1320	40 x 1320mm (22394 2)	NEW	40	1320	1200	1
HMAX45-520	45 x 520mm (23343 9)	NEW	45	520	400	1
HMAX50-520	50 x 520mm (23344 6)	NEW	50	520	400	1



heller

SDS Plus
2-Cutter SET-SAFE DE
HELLER DUSTER EXPERT CASE (29730 1)

For use with "M" Class vacuums ≥40 litres/sec airflow,
≥200 mbar suction & max hose length 5 metres



heller SDS Plus SET-SAFE DE - CASE
Inc 6mm, 8mm & 10mm



Part No.	Description		mm	mm	mm	qty
HDBOX-DE	SDS PLUS DE 6 x 220 - 2 Cutter	NEW	6	220	100	1
	SDS PLUS DE 8 x 220 - 2 Cutter		8	220	100	1
	SDS PLUS DE 10 x 220 - 2 Cutter		10	220	100	1
	PLUS 1 rubber connector					1
	PLUS Handy Instruction Leaflet					1

iccons.com.au/iconx



24/7 ACCESS

- Locate ICCONS®extensive Dealer Network
- Nationwide On-Site and Online Technical Support
- Extensive Product Information
- Access to Product Brochures, Tech Data Sheets, and MSDS
- Keep up-to-date with the world of ICCONS®
- Access ICCONS®Adhesive Volume Calculator
- Download our Anchor Design Software for Design Engineers
- And so much more!



PTA

POWER TOOL ACCESSORIES

ICCONS® FASTDRIVE QUALITY RANGE OF DRIVE BITS, NUT SETTERS & ACCESSORIES WILL MAKE YOUR FASTENING JOBS EASY!

Rest Assured, ICCONS® dedication to provide quality products to our independent dealers and end-users continues to evolve with the FAST-DRIVE POWER TOOL ACCESSORY (PTA) range.

The fast drive range compliments the already extensive Power Tool Accessories range of Carbide Drilling, Diamond Cutting / Coring & Power Tools.

ICCONS® have produced simple and easy to identify packaging and displays, while industry standard colour coding assists with easy identification of the correct drive types.

Featuring

- Selection of both Standard & Impact bits
- Bit holders & tools
- Core range of Phillips Drive, Pozi Drive, Hex Drive, Square Drive & Nut-setters.
- Lengths include 25mm / 50mm / 75mm / 100mm / 150mm.

ICCONS® PTA Impact bits also provide a precision fit to help prevent stripping and reduce cam-out, the result is superior fastener installation. It all adds up to a bit that's better by design, resulting in ultimate bit life.



WHY CHOOSE ICCONS® IMPACT BITS?....

- Increased hardness specification for reduced wear
- Engineered torsion zone increases bit life up to 10x longer when compared to standard bits .
- High quality black phosphate corrosion resistant coating helps distinguish Impact bits from standard bits
- Industry standard colour coding to identify drive types

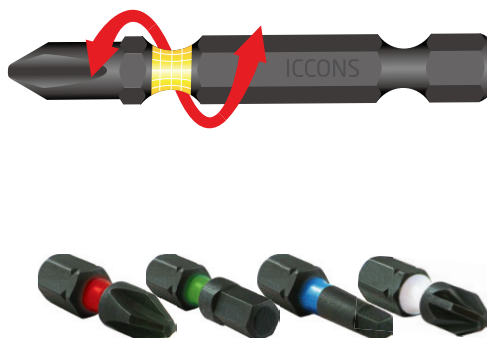
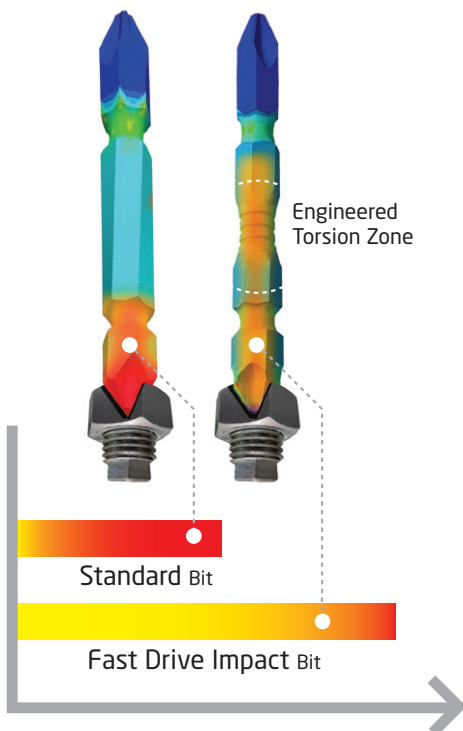



Impact Bit Kit 10Pce

9x Impact bits & 1x bit holder



IC Find #	Part No.	Description	Bit Length		
			mm	qty / pack	qty
BI-030	BTKIT1	10 Pce 25mm Insert Impact Bit Kit - (3 x Ph2, Sq2, Hx5 + 1x Bit Holder)	25	1	15

TRADE KIT - Impact Bit Kit 36Pce

36Pce Bit Kit Contents

25mm Insert Bits	50mm Power Bits	65mm Double End	Nut-setters	Bit Holder
2 x PZ2 4 x PH2 3 x PH3 2 x HX5, 2 x N°2 Sq 2 x T20 1 x T25 1 x T30	4 x PH2 2 x No2 Sq 2 x HX5 2 x T20 2 x T25	2 x PH2, 1 x 5mm Hex 1 x No. 2 Sq	1 x 1/4", 1 x 5/16" 1 x 3/8	1 x Kwik-Release Insert Bit Holder (BI-010)

NEW
AVAILABLE 2ND
QTR 2020



IC Find #	Part No.	Description	qty / pack	qty
BI-060	BTKIT36-1	36Pce Impact Bit Kit	1	6

BITZ-BOX Adjustable 7 compartment case



Load up with your Favourite Bits

Part No.	Description	qty
BITZ-BOX	Adjustable 7 Compartment Case 375mm (w) x 255mm(h)	1

Hex Drive

Standard

Bit Holder Standard - Magnetic with "C" Ring



Magnetic

"C" Ring

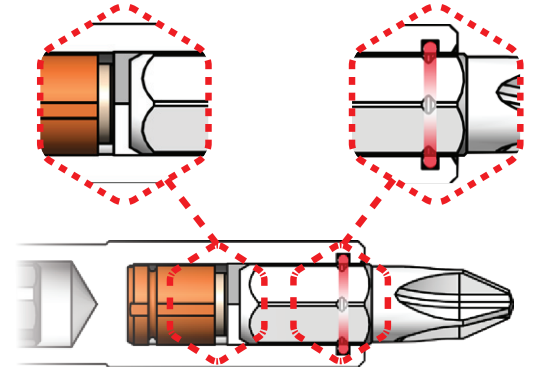

IC Find #	Part No.	Description	Length		
			mm	qty	qty
BS-016	BTSMBHC60	Standard Magnetic Bit Holder With C Ring - 1/4" hex x 60mm	60	3pce/pack	15 packs of 3
BS-018	BTSMBHC75	Standard Magnetic Bit Holder With C Ring - 1/4" hex x 75mm	75	3pce/pack	15 packs of 3

Hex Drive

Impact

Bit Holder Impact - Magnetic Quick release



slimline

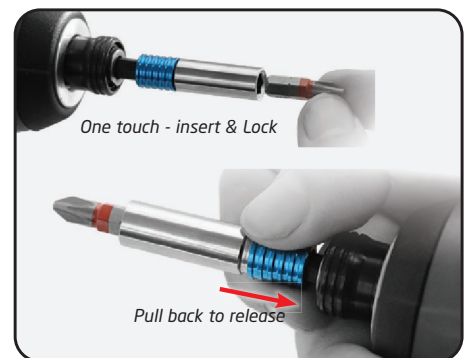
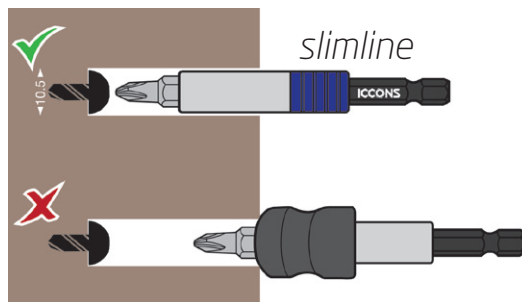

IC Find #	Part No.	Description	Length		
			mm	qty	qty
BI-010	BTIQRBH60	Impact Quick Release Magnetic Bit Holder - 1/4" hex x 60mm	60	1pce/pack	15 packs of 1



90° Drill Attachment - Quick release



- 5 Ball Bearing construction.
- Long life 8620 metal gears
- Perfect for difficult to reach screws
- Durable 6061 alloy Body
- Suitable for both Insert & Power Bits



IC Find #	Part No.	Description	Height without bit mm	qty / pack	qty
BI-050	BTRAQR	Right angle drill attachment with quick release bit holder	55	1	10

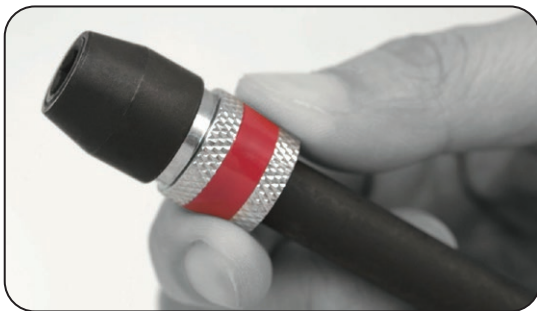

Extension Bit Quick release - 600mm

- Quick Release.
- Self-Locking - Eliminating unwanted bit tip releases.
- Suitable for 1/4 inch Power Bits.
- 600mm Length.
- Black phosphate corrosion resistant finish.
- Decking - Use from a standing position to save your back!



IC Find #	Part No.	Description	Length mm	qty / pack	qty
BS-025	BTQRE600	Quick Release Extension Bit - 1/4" hex x 600mm	600	1	n/a



Pozi Drive

Impact

Pozi Impact - Insert Bits

- Black Phosphate corrosion resistant finish
- Engineered torsion zone
- Up to 10x extended bit tip life
- Impact Rated
- Precision Tip reduces cam-out and stripping
- Colour-coded - White for Pozi drive
- Professional Quality - Made to handle high volume users



Length



Pozi Drive						
IC Find #	Part No.	Description	drive type	mm	qty	qty
BI-170	BTI050PZ2	Impact Insert Bit - 1/4" x 25mm PZ2	PZ2	25	10pce/pack	15 packs of 10

Phillips Drive

Standard

Phillips Standard - Insert & Power bits

- Precision Tip reduces cam-out and stripping
- Economical option
- Medium to high usage
- Colour-coded - Red for Phillips drive
- Trade quality - made from high quality S2 steel

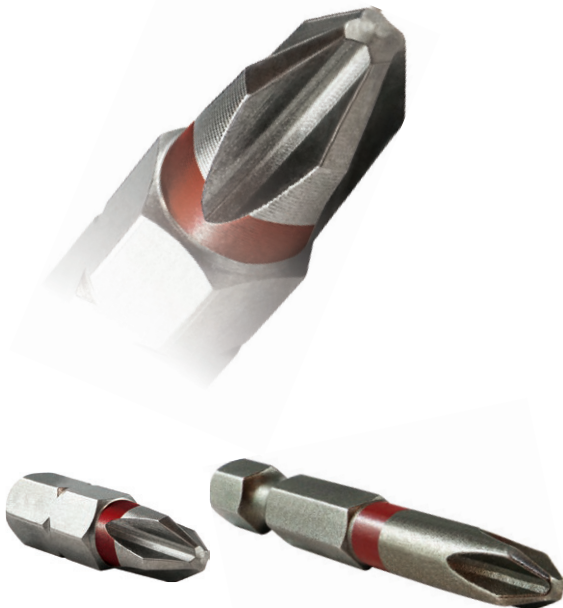

Length



Phillips No. 2						
IC Find #	Part No.	Description	drive type	mm	qty	qty
BS-110	BTS025PH2	Standard Insert Bit - 1/4" x 25mm PH2	PH2	25	10pce/pack	15 packs of 10
BS-112	BTS050PH2	Standard Power Bit - 1/4" x 50mm PH2	PH2	50	10pce/pack	15 packs of 10
BS-114	BTS075PH2	Standard Power Bit - 1/4" x 75mm PH2	PH2	75	10pce/pack	15 packs of 10
BS-116	BTS100PH2	Standard Power Bit - 1/4" x 100mm PH2	PH2	100	10pce/pack	15 packs of 10
BS-118	BTS150PH2	Standard Power Bit - 1/4" x 150mm PH2	PH2	150	10pce/pack	15 packs of 10

BS-110B	BTS025PH2-B	Standard Insert Bit - 1/4" x 25mm PH2 - BULK	PH2	25	100pce	NEW
BS-112B	BTS050PH2-B	Standard Power Bit - 1/4" x 50mm PH2 - BULK	PH2	50	100pce	



Phillips Impact - Insert & Power bits

- Black Phosphate corrosion resistant finish
- Engineered torsion zone
- Up to 10x extended bit tip life
- Impact Rated
- Precision Tip reduces cam-out and stripping
- Colour-coded - Red for Phillips drive
- Professional Quality - Made to handle high volume users

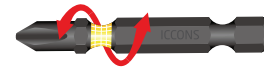

Phillips No. 2			+	Length		
IC Find #	Part No.	Description	drive type	mm	qty	qty
BI-110	BTI025PH2	Impact Insert Bit - 1/4" x 25mm PH2	PH2	25	10pce/pack	15 packs of 10
BI-112	BTI050PH2	Impact Power Bit - 1/4" x 50mm PH2	PH2	50	10pce/pack	15 packs of 10
BI-114	BTI075PH2	Impact Power Bit - 1/4" x 75mm PH2	PH2	75	10pce/pack	15 packs of 10
BI-116	BTI100PH2	Impact Power Bit - 1/4" x 100mm PH2	PH2	100	10pce/pack	15 packs of 10
BI-118	BTI150PH2	Impact Power Bit - 1/4" x 150mm PH2	PH2	150	10pce/pack	15 packs of 10

BI-110B	BTI025PH2-B	Impact Insert Bit - 1/4" x 25mm PH2 - BULK	PH2	25	100pce	NEW
BI-112B	BTI050PH2-B	Impact Power Bit - 1/4" x 50mm PH2 - BULK	PH2	50	100pce	
BI-116B	BTI100PH2-B	Impact Power Bit - 1/4" x 100mm PH2 - BULK	PH2	100	100pce	



Phillips Impact - Double ended

Phillips No. 2					
IC Find #	Part No.	Description	drive type	mm	qty
BI-150	BTIDE065PH2	Impact Double Ended Bit - 1/4" x 65mm PH2 x PH2	PH2	65	10pce/pack



Phillips Impact - Insert PH3

Phillips No. 3					
IC Find #	Part No.	Description	drive type	mm	qty
BI-120	BTI025PH3	Impact Insert Bit - 1/4" x 25mm PH3	PH3	25	10pce/pack



Hex Drive

Standard

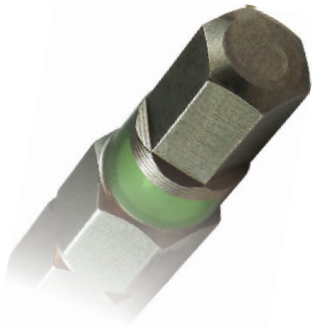

HEX Standard - Insert & Power bits

- Precision Tip reduces cam-out and stripping
- Economical option
- Medium to high usage
- Colour-coded - Green for Hex drive
- Trade quality - made from high quality S2 steel



Length



Hex Drive			drive type	mm	qty	qty
IC Find #	Part No.	Description				
BS-420	BTS025HX5	Standard Insert Bit - 1/4" x 25mm HX5	HX5	25	10pce/pack	15 packs of 10
BS-422	BTS050HX5	Standard Power Bit - 1/4" x 50mm HX5	HX5	50	10pce/pack	15 packs of 10

Hex Drive

Impact



Hex Impact - Insert & Power bits

- Black Phosphate corrosion resistant finish
- Engineered torsion zone
- Up to 10x extended bit tip life
- Impact Rated
- Precision Tip reduces cam-out and stripping
- Colour-coded - Green for Hex drive
- Professional Quality - Made to handle high volume users



Length



Hex Drive			drive type	mm	qty	qty
IC Find #	Part No.	Description				
BI-420	BTI025HX5	Impact Insert Bit - 1/4" x 25mm HX5	HX5	25	10pce/pack	15 packs of 10
BI-422	BTI050HX5	Impact Power Bit - 1/4" x 50mm HX5	HX5	50	10pce/pack	15 packs of 10



Hex Impact - Double ended

Hex Drive			drive type	mm	qty	qty
IC Find #	Part No.	Description				
BI-450	BTIDE065HX5	Impact Double Ended - 1/4" x 65mm HX5 x HX5	PH2	65	10pce/pack	15 packs of 10



Square Standard - Insert & Power bits

- Precision Tip reduces cam-out and stripping
- Economical option
- Medium to high usage
- Colour-coded - Blue for Square drive
- Trade quality - made from high quality S2 steel



Square Drive				Length		
IC Find #	Part No.	Description	drive type	mm	qty	qty
BS-310	BTS025SQ2	Standard Insert Bit - 1/4" x 25mm SQ2	SQ2	25	10pce/pack	15 packs of 10
BS-312	BTS050SQ2	Standard Power Bit - 1/4" x 50mm SQ2	SQ2	50	10pce/pack	15 packs of 10

Square Impact - Insert & Power bits

- Black Phosphate corrosion resistant finish
- Engineered torsion zone
- Up to 10x extended bit tip life
- Impact Rated
- Precision Tip reduces cam-out and stripping
- Colour-coded - Blue for Square drive
- Professional Quality - Made to handle high volume users



Square Drive				Length		
IC Find #	Part No.	Description	drive type	mm	qty	qty
BI-310	BTI025SQ2	Impact Insert Bit - 1/4" x 25mm SQ2	SQ2	25	10pce/pack	15 packs of 10
BI-312	BTI050SQ2	Impact Power Bit - 1/4" x 50mm SQ2	SQ2	50	10pce/pack	15 packs of 10
BI-316	BTI100SQ2	Impact Power Bit - 1/4" x 100mm SQ2	SQ2	100	10pce/pack	15 packs of 10

Square Impact - Double ended



Square Drive				Length		
IC Find #	Part No.	Description	drive type	mm	qty	qty
BI-350	BTIDE065SQ2	Impact Double Ended - 1/4" x 65mm SQ2 x SQ2	SQ2	65	10pce/pack	15 packs of 10



Torx Drive

Impact



NEW

Torx Impact - Insert & Power bits

- Black Phosphate corrosion resistant finish
- Engineered torsion zone
- Up to 10x extended bit tip life
- Impact Rated
- Precision Tip reduces cam-out and stripping
- Colour-coded - Purple for Torx drive
- Professional Quality - Made to handle high volume users



Torx Drive				Length		
IC Find #	Part No.	Description		mm	qty	qty
BI-602	BTI050T20	Impact Power Bit - 1/4" x 50mm Torx 20	T20	50	10pce/pack	15 packs of 10
BI-692	BTI050T25	Impact Power Bit - 1/4" x 50mm Torx 25	T25	50	10pce/pack	15 packs of 10
BI-612	BTI050T30	Impact Power Bit - 1/4" x 50mm Torx 30	T30	50	10pce/pack	15 packs of 10
BI-622	BTI050T40	Impact Power Bit - 1/4" x 50mm Torx 40	T40	50	10pce/pack	15 packs of 10
BI-632	BTI050T45	Impact Power Bit - 1/4" x 50mm Torx 45	T45	50	10pce/pack	15 packs of 10
BI-642	BTI050T50	Impact Power Bit - 1/4" x 50mm Torx 50	T50	50	10pce/pack	15 packs of 10

Follow Us



Facebook
ICCONS Pty Ltd

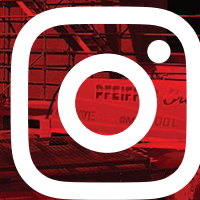

LinkedIn
ICCONS Pty Ltd



Instagram
iccons.ptyltd



Torx Impact - 1/2" Socket Drive

- Black Phosphate corrosion resistant finish
- Up to 10x extended bit tip life
- Impact Rated
- Precision Tip reduces cam-out and stripping
- Professional Quality - Made from SNCM+V - CRMO Alloy Steel



NEW



Socket Drive Torx			Length		
Part No.	Description		mm	qty	qty
BTISTX30	Impact - 1/2" socket drive - Torx 30	T30	60	1	10
BTISTX40	Impact - 1/2" drive socket - Torx 40	T40	77	1	10
BTISTX45	Impact - 1/2" drive socket - Torx 45	T45	77	1	10

Counter Display Unit Rotating 3 face

- Suitable for counter top display
- 1040mm(h) x 580mm(w) x 510mm(D) (unit only)
- Can hold up to 720 sku's (depends on stock selected)
- 360° Rotation
- 3 faces for stock
- Adjustable pegs



Part No.	Description	
YDSBTCDU	Counter display Unit	1

Nut-Setter
Standard

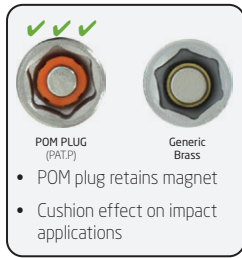

Nut-Setter Standard - 1/4", 5/16" & 3/8"

- Trade quality - made from high quality S2 steel
- Economical option
- Impact Resisting
- Medium to high usage
- Magnet retained with POM Plug (patent pending)



Nut-Setter				Length		
IC Find #	Part No.	Description	internal	mm	qty	qty
BS-510	BTS065NS14	Standard Nut Setter- 1/4" x 65mm 1/4"	1/4"	65	3	15
BS-512	BTS065NS516	Standard Nut Setter- 1/4" x 65mm 5/16"	5/16"	65	3	15
BS-522	BTS150NS516	Standard Nut Setter- 1/4" x 150mm 5/16"	5/16"	150	3	15
BS-514	BTS065NS38	Standard Nut Setter- 1/4" x 65mm 3/8"	3/8"	65	3	15

Nut-Setter
Impact

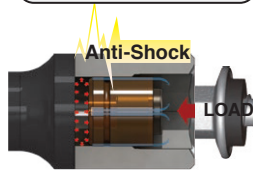
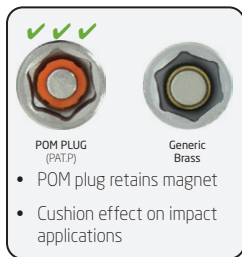

Nut-Setter Impact - 1/4", 5/16" & 3/8"

- Black Phosphate corrosion resistant finish
- Up to 10x extended life
- Impact Rated
- Anti-shock magnet for high-impact environments
- Colour Coded — Red - 1/4", Yellow - 5/16" & Blue - 3/8"
- Professional Quality - Made to handle high volume users



Nut-Setter				Length			
IC Find #	Part No.	Description	internal	mm	qty	qty	
BI-510	BTI065NS14	Impact Nut Setter- 1/4" x 65mm 1/4"		1/4"	65	3	15
BI-512	BTI065NS516	Impact Nut Setter- 1/4" x 65mm 5/16"		5/16"	65	3	15
BI-522	BTI150NS516	Impact Nut Setter- 1/4" x 150mm 5/16"		5/16"	150	3	15
BI-514	BTI065NS38	Impact Nut Setter- 1/4" x 65mm 3/8"		3/8"	65	3	15

Nut-Setter				Length	qty	qty
IC Find #	Part No.	Description	internal	mm	qty	qty
BI-512B	BTI065NS516-B	Impact Nut Setter- 1/4" x 65mm 5/16" - BULK	5/16"	65	50pce	
BI-522B	BTI150NS516-B	Impac Nut Setter- 1/4" x 150mm 5/16" - BULK	5/16"	150	50pce	

NEW



Nut-Setter Impact - Pressure Fit

- Non - magnetic
- No more wobbly installs from swarf build up
- Pressure fit holds the screw firmly in place via 3 ball bearings & spring clip
- Ideal for Stainless Steel & Carbon Steel fasteners
- Impact Rated
- Great choice for Roofing Screws

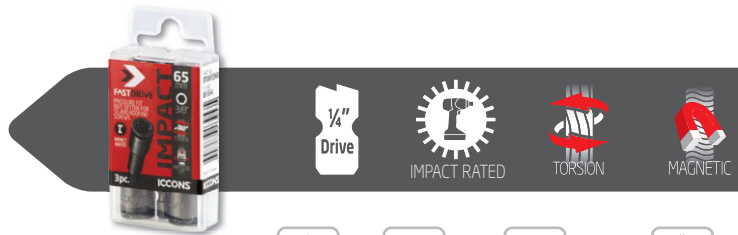

Nut-Setter for SS Screws				Length		
IC Find #	Part No.	Description	internal	mm	qty	qty
BI-562	BTI065SSNS516	Impact Nut Setter- 1/4" x 65mm 5/16"	5/16"	65	3	15
BI-564	BTI065SSNS38	Impact Nut Setter- 1/4" x 65mm 3/8"	3/8"	65	3	15

MAGNETIC NUT SETTERS

ADVANTAGES OF THE ICCONS® IMPACT & IMPACT-RESISTANT MAGNETIC NUT-SETTERS....

- Specially engineered orange POM PLUG (Pat.P) delivers cushion effect on impact applications and absorbs the impact load.
- In order to maximize the strength of the magnet, The POM PLUG (Pat.P) adjusts its position to suit different heights of hex head screws.



Broken & loss of Magnet can occur on standard Nut Setters without the POM plug, as experienced with some competitor nut-setters

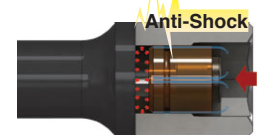
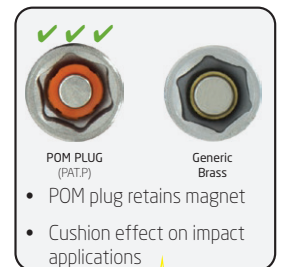

NON-MAGNETIC NUT SETTERS

ICCONS® PRESSURE FIT NON-MAGNETIC NUT-SETTERS ARE THE WAY TO GO....

- Non - magnetic
- No more wobbly installs from swarf build up
- Pressure fit holds the screw firmly in place via 3 ball bearings & spring clip
- Ideal for Stainless Steel & Carbon Steel fasteners
- Impact Rated
- Great choice for Roofing Screws

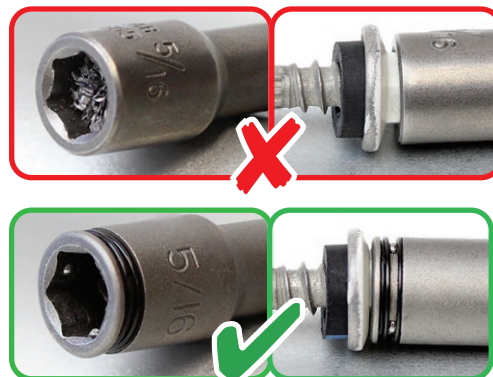

KARAT[®] 180

NEW
Coming soon
3rd QTR 2020

Optional accessory
**ADJUSTABLE
SHOULDER PAD**
for more safety and
stability

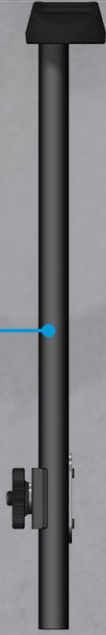

ELECTRONICS

Latest generation RGB LED's, clearer colours with flexible colour options.

- | **Normal machine operation:** 2 blue, 4 green, 2 red
- | **Overload and Pulse:** All LED's flashing full red/green, then full red
- | **Electronic Slip is activated:**
All LED's flashing red until trigger is deactivated and activated again.
Machine stops rotating.
- | **Slow Start and 50% Speed Reduction:** 1 purple
- | **Under-voltage protection:** All LED's full blue. Machine stops.



Optional accessory
Extra handgrip

2400W

More Powerful Motor
through Advanced
Motor Control

ERGONOMIC GRIP

6,8 KG

More Compact and
Lower Weight

LOWER RPM

for increased motor life

SLOW SPEED START

ROTATABLE

water connector

AUTO-OFF

when Drill Bit is jammed

BIT RANGE

Increased Bit Range for:

- | **Handheld Drilling:** Ø 8 - 122 mm
- | **On Drill Stand:** Ø 8 - 180 mm
- | **Dry Drilling:** Ø37 - 202 mm
- | **Wet Drilling:** Ø 8 - 180 mm

Optional accessory

Dry Drilling Adapter

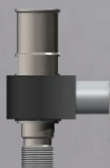

B+BTEC



Handheld or Rig Mounted

KARAT® 180



DONE AND
DUSTLESS



Optional Drill Stand

For up to 180mm core bits

- LED Motor Overload Protection System.
- Water Levels aid the operator in keeping the machine level.
- 360° Auxiliary Handle.
- 3-Speed Gearing for optimal drilling.
- Performance at any Diameter.
- Powerful 2400W Drill Motor with PULSE Electronic Motor Protection.
- Professional Grade Aluminium Motor Housing.
- Water flow Indication.
- Back Grip Handle.
- Rotating Water Valve to prevent damage.
- ½" - 1¼" combi spindle.
- Full Range of HiSpeed Diamond Core Bits.

NEW
Coming soon
3rd QTR 2020

Part#	DCTDK180
Power:	2400 W
Voltage / Frequency / Gears	230V / 50-60Hz / 3
Bit Range:	Ø 8 - 180 mm
handheld drilling	Ø 8 - 70 mm (not to be used in 1st gear)
Rig mounted drilling	Ø 8 - 180 mm
Spindle threading:	½" - 1¼"
Weight:	6.8 kg

iccons.com.au/iconx

POWERED BY ICCONS®



24/7 ACCESS

- Locate ICCONS®extensive Dealer Network
- Nationwide On-Site and Online Technical Support
- Extensive Product Information
- Access to Product Brochures, Tech Data Sheets, and MSDS
- Keep up-to-date with the world of ICCONS®
- Access ICCONS®Adhesive Volume Calculator
- Download our Anchor Design Software for Design Engineers
- And so much more!

ICCONS® PTY LTD

VICTORIA - HEAD OFFICE

383 Frankston- Dandenong Road,
Dandenong South, Victoria, 3175

P: **03 9706 4344**

F: **03 9768 3329**

E: **sales@iccons.com.au**

NSW Branch

Unit A, 17 Seddon Street, Bankstown,
New South Wales, 2200

P: **02 9791 6869**

F: **02 9790 8404**

E: **salesnsw@iccons.com.au**

QLD Branch

42-44 Nealdon Drive, Meadowbrook,
Queensland, 4131

P: **07 3200 6455**

F: **07 3299 7548**

E: **salesqld@iccons.com.au**

S.A Branch

29-31 Weaver St, Edwardstown,
South Australia, 5039

P: **08 8234 5535**

F: **08 8354 4689**

E: **salessa@iccons.com.au**

W.A. Branch

90 Christable Way, Landsdale,
Western Australia, 6065

P: **08 6305 0008**

F: **08 6305 0011**

E: **saleswa@iccons.com.au**

NORTHERN TERRITORY

Unit 1, 14 Menmuir Street, Winnellie,
Northern Territory 0820

P: **08 8947 2758**

F: **08 8947 2758**

E: **salesnt@iccons.com.au**

NEW ZEALAND

Sesto Fasteners

5E Piermark Drive, Albany, Auckland,
New Zealand 0630

P: **+64 09 415 8564**

E: **sestofasteners@gmail.com**

ICCONS (Thailand) Co. Ltd.

55 Phetkasem 62/3, Bangkhae,
Bangkok 0160

P: **+ 66 2 801 0764**

F: **+ 66 2 801 0764**

M: **+ 66 8 1 710 8745**

E: **icconsthailand@hotmail.com**

